

# LOCK-NUT : RN SERIES

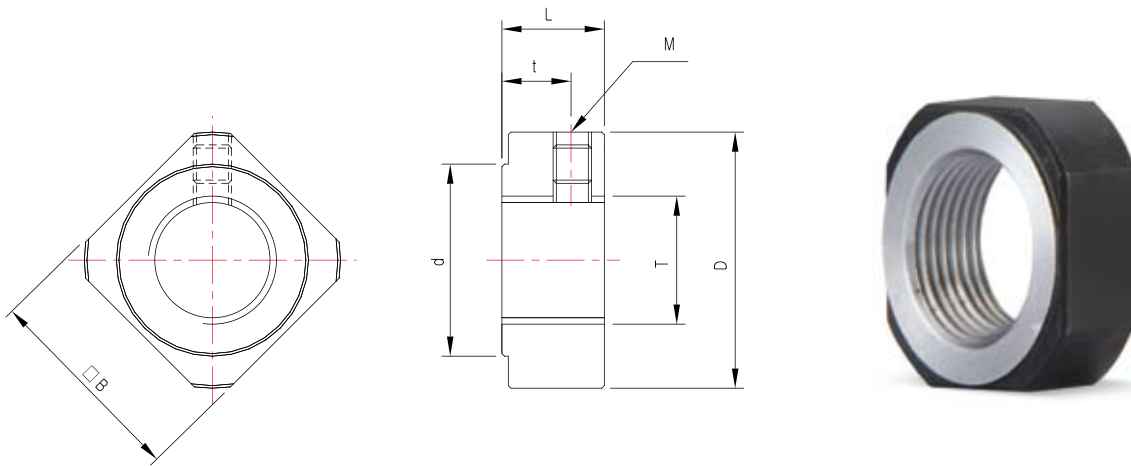

## LOCK-NUT (GENERAL LOAD)



### Dimensions

| Model        | Sizes (mm) |         |      |     |     |     |    | Fastening Torque (N.m) | Mass (g) |
|--------------|------------|---------|------|-----|-----|-----|----|------------------------|----------|
|              | T          | M       | D    | d   | L   | t   | B  |                        |          |
| RN4          | M4×0.5     | M3×0.5  | 11   | 8.5 | 5   | 2.7 | 10 | 1.6                    | 4        |
| RN5          | M5×0.5     | M3×0.5  | 13   | 9   | 5   | 2.7 | 11 | 2                      | 5        |
| RN6          | M6×0.75    | M3×0.5  | 14.5 | 10  | 5   | 2.7 | 12 | 2.5                    | 5        |
| RN8          | M8×1       | M3×0.5  | 17   | 13  | 6.5 | 4   | 14 | 5                      | 8        |
| RN8 (0.75P)  | M8×0.75    | M3×0.5  | 17   | 13  | 6.5 | 4   | 14 | 5                      | 8        |
| RN10         | M10×1      | M4×0.7  | 20   | 15  | 8   | 5.5 | 16 | 9.5                    | 10       |
| RN10 (0.75P) | M10×0.75   | M4×0.7  | 20   | 15  | 8   | 5.5 | 16 | 9.5                    | 10       |
| RN12         | M12×1      | M4×0.7  | 22   | 17  | 8   | 5.5 | 19 | 14                     | 14       |
| RN15         | M15×1      | M4×0.7  | 25   | 21  | 8   | 4.5 | 22 | 24                     | 15       |
| RN17         | M17×1      | M4×0.7  | 30   | 25  | 13  | 9   | 24 | 35                     | 17       |
| RN20         | M20×1      | M4×0.7  | 35   | 26  | 11  | 7   | 30 | 48                     | 35       |
| RN25         | M25×1.5    | M5×0.8  | 43   | 33  | 15  | 10  | 35 | 86                     | 45       |
| RN30         | M30×1.5    | M6×1    | 48   | 39  | 20  | 14  | 40 | 128                    | 80       |
| RN35         | M35×1.5    | M8×1.25 | 60   | 46  | 21  | 14  | 50 | 192                    | 130      |
| RN40         | M40×1.5    | M8×1.25 | 63   | 51  | 25  | 18  | 50 | 256                    | 235      |