

Multi-Beam

Aluminium Multi-Helix Flexible 6 Beam Couplings Non-Relieved

Set Screw Hubs

Clamp Hubs

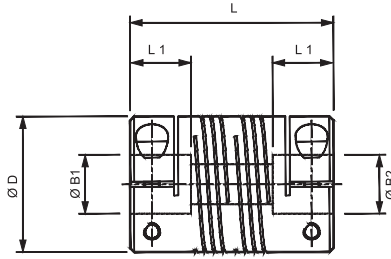
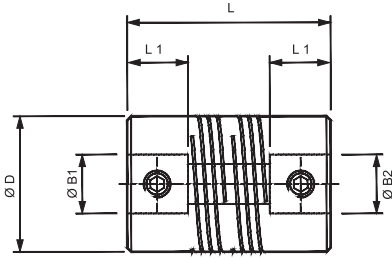

Materials & Finishes

Couplings: Aluminium L168 or better

Fasteners: Alloy steel, black oiled

Temperature Range

-40°F to +284°F

(-40°C to +120°C)

6-BEAM COUPLINGS: DIMENSIONS & ORDER CODES

Coupling Type & Size	Set Screw Style	Clamp Type	ØD in. (mm)	L in. (mm)	L1 in. (mm)	Bore Diameters			Mass kgx10-3	Fasteners				Angular Offset Deg.	Parallel Offset mm	Torsional Stiffness Nm/rad	Peak Torque lb.in (Nm)
						Min B1	Min B2	Max B1 & B2		Set Screw	Cap Screw	Torque lbs.-in. (Nm)	Wrench in. (mm)				
Non-Relieved	09	706.09	0.4 (9.5)	0.77 (19.6)	0.21 (5.3)	2.0	3.0	4.76	2.85	M2.5	-	4.87 (0.55)	0.51 (1.3)	3.0	.002 (0.12)	1.8	8.85 (1.0)
		-	707.09								-	M1.6	2.60 (0.29)				
	13	706.13	0.5 (12.7)	.09 (22.9)	0.26 (6.5)	3.0	4.0	6.35	5.5	M3	-	8.0 (0.90)	0.59 (1.5)	5.0	.007 (0.17)	14.0	17.7 (2.0)
		-	707.13								-	M2	5.84 (0.66)				
	16	706.16	0.63 (15.9)	1.00 (25.4)	0.26 (6.5)	3.0	4.0	8	9.8	M4	-	22.1 (2.5)	.098 (2.5)	5.0	.008 (0.2)	27.0	30.09 (3.4)
		-	707.16								-	M2.5	11.5 (1.3)				
	19	706.19	0.75 (19.1)	1.04 (26.5)	0.26 (6.5)	4.76	5.0	10	14.0	M4	-	22.1 (2.5)	.098 (2.5)	7.0	0.01 (0.25)	46.0	46.9 (5.3)
		-	707.19								-	M3	11.5 (1.3)				
	25	706.25	1.00 (25.4)	1.50 (38.1)	0.43 (11.0)	5.0	6.0	12.7	38.0	M5	-	40.7 (4.6)	.098 (2.5)	7.0	.015 (0.38)	108	88.5 (10.0)
		-	707.25								-	M3	21.2 (2.4)				
	32	706.32	1.25 (31.8)	2.25 (57.2)	0.63 (16.0)	8.0	9.53	19.0	92.0	M6	-	67.3 (7.6)	0.12 (3.0)	7.0	0.02 (0.5)	225	132.8 (15.0)
		-	707.32					16.0			-	M4	49.6 (5.6)				
	38	706.38	1.25 (38.1)	2.63 (66.7)	0.71 (18.0)	8.0	12.0	22.0	154	M6	-	67.3 (7.6)	0.12 (3.0)	7.0	.024 (0.6)	315	194.7 (22.0)
		-	707.38					19.0			-	M5	97.4 (11.0)				
	44	706.44	1.75 (44.5)	3.00 (76.2)	0.79 (20.0)	9.0	14.0	25.0	239	M6	-	67.3 (7.6)	0.11 (3.0)	7.0	.031 (0.8)	459	265.5 (30.0)
		-	707.44					22.0			-	M5	97.4 (11.0)				
51	706.51	2.00 (50.8)	3.75 (95.3)	0.98 (25.0)	10.0	16.0	28.0	389	M8	-	159 (18)	0.16 (4.0)	7.0	0.35 (0.9)	666	354 (40.0)	
	-	707.51					26.0			-	M6	168 (19)					0.20 (5.0)
57	706.57	2.25 (57.2)	5.12 (130)	1.26 (32.0)	10.0	20.0	32.0	674	M8	-	159 (18)	0.16 (4.0)	7.0	.037 (0.95)	918	486.8 (55.0)	
	-	707.57					30.0			-	M6	168 (19)					0.20 (5.0)
64	706.64	2.5 (63.5)	5.91 (150)	1.5 (38.0)	12.0	25.0	38.0	1118	M8	-	159 (18)	0.16 (4.0)	7.0	0.39 (1.0)	1125	663.8 (75.0)	
	-	707.64					36.0			-	M8	407 (46)					0.24 (6.0)

① Length of supported bore.

③ **Peak torque.** Select a size where Peak Torque exceeds the application torque x service factor. (see page 4)

② Max. compensation values are mutually exclusive.

BORE SIZES 6-BEAM COUPLINGS, NON-RELIEVED

○ B1 only

● B1 & B2

Sizes indicated in parenthesis are metric (mm).

Coupling Size	ØB1, ØB2 +0.0012/ -0 (+0.03mm/-0mm)																															
	(2)	(3)	1/8"	(4)	3/16"	(5)	(6)	1/4"	(8)	3/8"	(10)	(12)	1/2"	(14)	5/8"	(16)	(18)	(19)	3/4"	(20)	(24)	(25)	1"	(28)	(30)	1 1/4"	(32)					
9	○	○	○	●	●																											
13		○	○	○	○	●	●	●																								
16		○	○	○	○	○	●	●																								
19					○	○	○	●	●	●																						
25						○	○	○	●	●	●	●	●																			
32									○	●	●	●	●	●	●	●																
38									○	○	●	●	●	●	●	●	●	●	●	●												
44										○	○	○	○	○	○	○	○	○	○	○	○	○	○	○	○	○	○	○	○			
51											○	○	○	○	○	○	○	○	○	○	○	○	○	○	○	○	○	○	○			
57											○	○	○	○	○	○	○	○	○	○	○	○	○	○	○	○	○	○	○			
64											○	○	○	○	○	○	○	○	○	○	○	○	○	○	○	○	○	○	○			
Bore ref.	11	14	16	18	19	20	22	24	28	31	32	35	36	38	41	42	45	46	47	48	51	52	53	54	56	57	58					