

Multi-Beam

Stainless Steel Multi-Helix Flexible 3 Beam Couplings

Set Screw Hubs

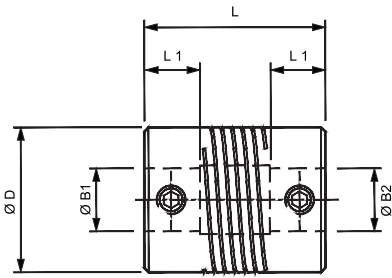

Clamp Hubs

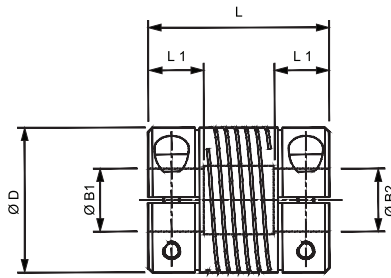

Materials & Finishes

Couplings: Stainless Steel 303 S31

Fasteners: Stainless Steel

Temperature Range

-40°F to +284°F

(-40°C to +140°C)

3-BEAM COUPLINGS: DIMENSIONS & ORDER CODES

Coupling Type & Size	Set Screw Style	Clamp Type	ØD in. (mm)	L in. (mm)	L1 in. (mm)	Bore Diameters			Mass kgx10 ⁻³	Fasteners				Angular Offset Deg.	Parallel Offset mm	Torsional Stiffness Nm/rad	Peak Torque lb.in (Nm)	
						Min B1	Min B2	Max B1 & B2		Set Screw	Cap Screw	Torque lbs.-in. (Nm)	Wrench in. (mm)					
Relieved	6	720.06	-	.25 (6.4)	0.5 (12.7)	.13 (3.2)	1.0	2.0	3.0	1.93	M2	-	0.71 (0.08)	.035 (0.9)	3	.003 (.07)	1.53	3.98 (0.45)
	9	720.09	-	.37 (9.5)	.56 (14.2)	.18 (4.5)	2.0	3.0	3.18	5.85	M2.5	-	2.04 (0.23)	.051 (1.3)	3	.004 (0.1)	16	4.43 (0.50)
		-	721.09	-								-	M1.6	1.33 (0.15)				
	13	720.13	-	0.5 (12.7)	.75 (19.1)	.24 (6.0)	3.0	4.0	5.0	13.7	M3	-	2.83 (0.32)	.059 (1.5)	5	.005 (.127)	54	8.85 (1.0)
		-	721.13	-								-	M2	2.66 (0.30)				
	16	720.16	-	.63 (15.9)	.80 (20.3)	.26 (6.5)	3.0	4.0	6.35	22.9	M4	-	9.29 (1.05)	.079 (2.0)	5	.005 (.127)	81	15.9 (1.80)
		-	721.16	-								-	M2.5	6.02 (0.68)				
	19	720.19	-	.75 (19.1)	.90 (22.9)	.26 (6.5)	4.0	4.76	8.0	35.9	M4	-	9.29 (1.05)	.079 (2.0)	5	.005 (.127)	143	23.9 (2.70)
		-	721.19	-								-	M2.5	6.02 (0.68)				
	25	720.25	-	1.0 (25.4)	1.25 (31.8)	.35 (9.0)	5.0	6.0	10	92.2	M5	-	18.6 (2.10)	.098 (2.5)	5	.005 (.127)	175	53.1 (6.0)
		-	721.25	-								-	M3	10.6 (1.20)				
	32	720.32	-	1.25 (31.8)	1.75 (44.5)	.47 (12.0)	6.0	8.0	14	194	M6	-	33.2 (3.75)	0.12 (3.0)	5	.005 (.127)	378	88.5 (10.0)
-		721.32	-								-	M4	25.2 (2.85)	0.12 (3.0)				

BORE SIZES 3-BEAM COUPLINGS

Sizes indicated in parenthesis are metric (mm).

Coupling Size	ØB1, ØB2 +0.0012/ -0 (+0.03mm/-0mm)														
	(1)	(2)	(3)	1/8"	(4)	3/16"	(5)	(6)	1/4"	(8)	3/8"	(10)	(12)	1/2"	(14)
6	○	●	●												
9		○	●	●											
13			○	○	●	●	●								
16			○	○	●	●	●	●	●						
19					○	●	●	●	●	●					
25						○	●	●	●	●	●				
32							○	○	●	●	●	●	●	●	●
Bore ref.	8	11	14	16	18	19	20	22	24	28	31	32	35	36	38

○ B1 only ● B1 & B2